



WELCOME TO
RAIDERLAND

2022-2023
TEXAS TECH UNIVERSITY
University Student Housing

TABLE OF CONTENTS

RESERVE YOUR ROOM	4	RESIDENCE HALLS	
Housing Deposit Information.....	5	MOVEABLE FURNITURE	10
WHY LIVE ON-CAMPUS?	6	Sneed Hall	10
Residential Tutoring Program	6	Horn/Knapp Hall.....	10
Learning Communities 2022-2023.....	7	SUITE-STYLE LIVING	12
RESIDENCE HALLS		Murray Hall	12
BUILT-IN FURNITURE	8	Talkington Hall	13
Stangel/Murdough Complex	8	Gordon Hall	14
Chitwood/Weymouth/Coleman	8	Carpenter/Wells	16
Hulen/Clement Complex	8		
Wall/Gates Complex	9		



APARTMENT-STYLE LIVING18
 West Village18
POD-STYLE LIVING.....20
 Honors Hall20
RATES FOR FALL 2022-SPRING 2023 .22

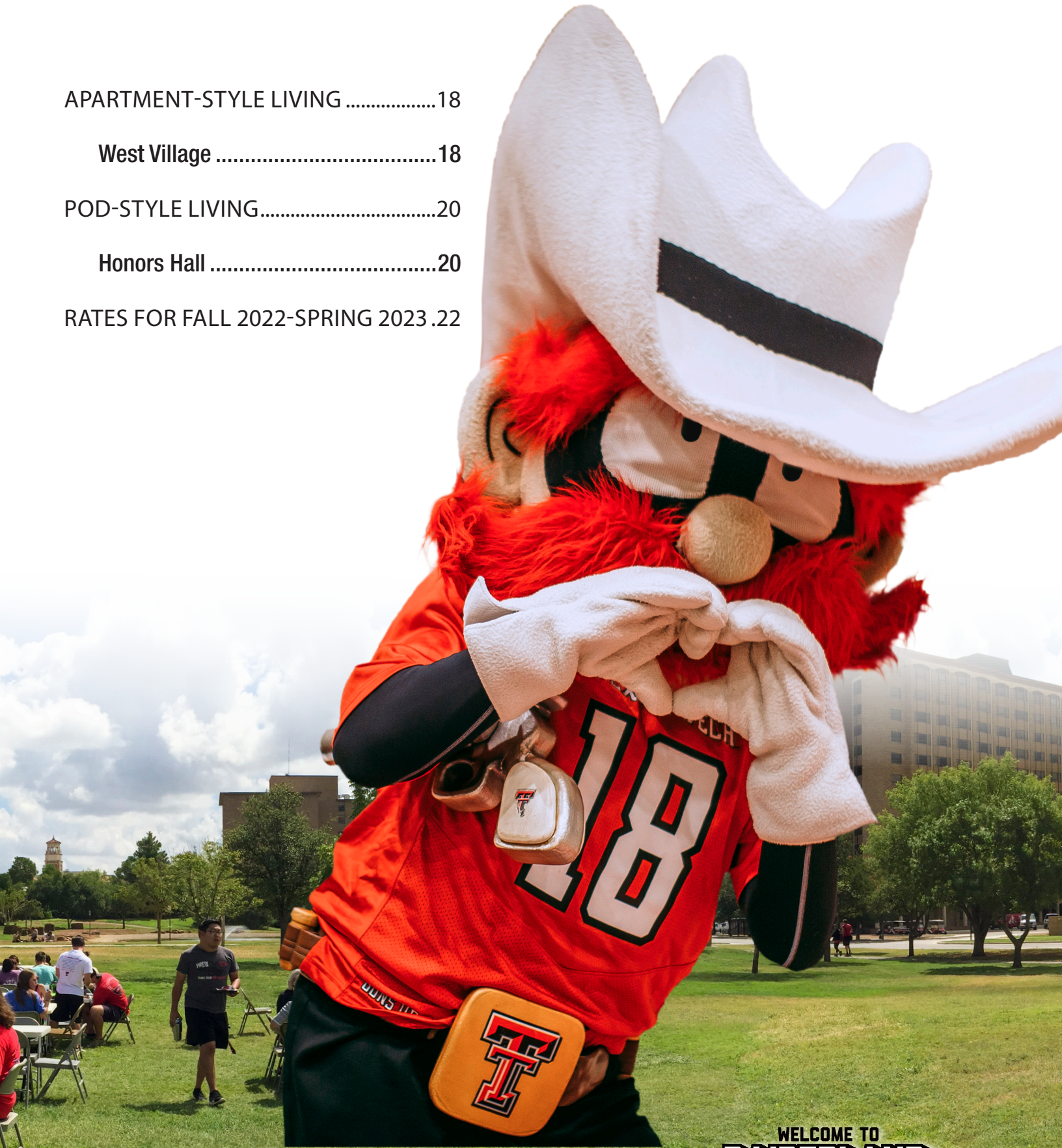

HOUSING SIGN-UP PROCESS

1

You must be admitted to Texas Tech University

2

Sign in with your eRaider and password at housing.ttu.edu

3

Select a Learning Community or Residence Hall from the available options.

4

Sign the contract electronically (if you are under 18 years old, parent/guardian signature is also required)

5

Pay the Application Fee (\$75), Initial Deposit (\$400), and possibly an Additional Deposit* (\$250) to complete the application

6

Select a room and a required dining plan

PRO TIP

If you have a roommate preference, plan to sign-up at the same time

*All suites/pod/apt style residence halls require an Additional Deposit of \$250.

HOUSING DEPOSIT INFORMATION

- » A one-time \$75 non-refundable application fee is required with all housing applications.
- » A \$400 Initial Deposit is required for all housing room reservations for ALL halls including traditional spaces and suites/apartment/pods style spaces. The \$400 Initial Deposit is potentially refundable (less any fees or billed charges) if the contract is completed or properly canceled. *

Cancellation Schedule

Contract Period	Deadline	Refund
Fall 2022 – Spring 2023	Cancellations received on or before May 1, 2022	\$400
Fall 2022 – Spring 2023	Cancellations received on or before May 1, 2022	\$0

- » A \$250 Additional Deposit is required for housing room reservations in a suite/apartment/pod style space. Payment of the additional deposit does NOT guarantee you a room in a suite/apartment/pod style space. The \$250 additional deposit is potentially refundable (less any fees or billed charges) if the contract is completed or if the student NEVER reserves a suite/apartment/pod style space. The \$250 additional deposit is non-refundable if the contract is canceled at any time before the end of the contract period. If a suite/apartment/pod style space is reserved, then the reservation is changed to a traditional space, the student will forfeit the \$250 additional deposit.

*Please review the Housing and Dining Contract for proper cancellation procedures.

Deferral

To apply for a deferral of the Initial Deposit of \$400 please email your request to housing@ttu.edu. Our offices will follow up with you on your request.



WHY LIVE ON-CAMPUS?

STUDENTS ON-CAMPUS HAVE BETTER GRADES

National Research indicated that students living on campus maintain a higher grade point average and are more likely to graduate. Therefore, the Board of Regents of Texas Tech University supports an On Campus Residence Requirement to give new students a greater chance of achieving their educational goals.

Some students may be exempt from the On Campus Residency Requirement. For more information, please visit:

housing.ttu.edu/exemptions

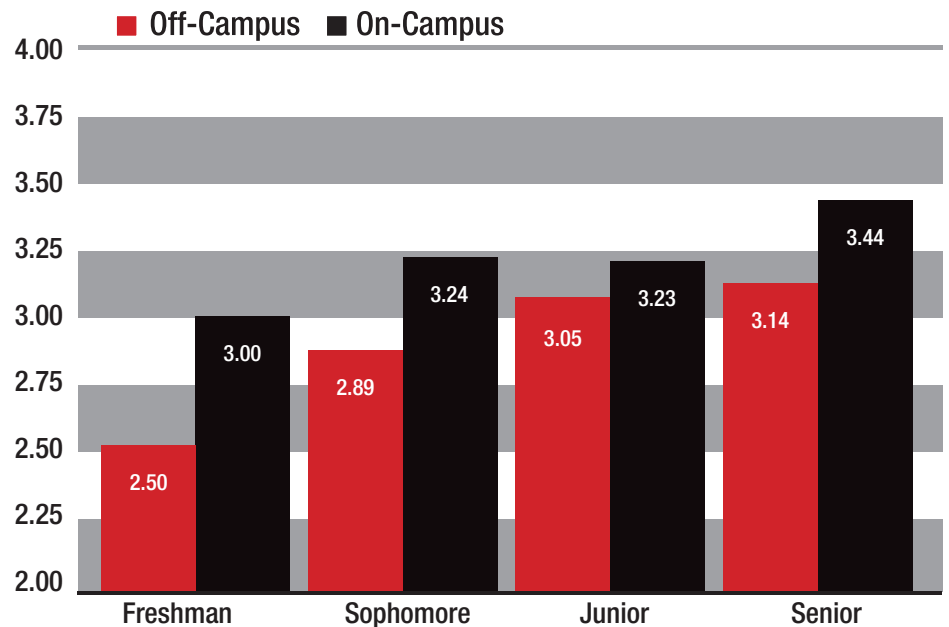

Fall 2020 GPA Comparison

Source: Texas Tech University Office of Institutional Research. 2020.

RESIDENTIAL TUTORING PROGRAM

The Residential Tutoring program provides academic tutoring services for students in the residence halls. Residential Tutoring is a free service to all students living on campus. Sunday through Wednesday, 7 pm–10 .m

Chemistry | Math | Writing Any subject | Political Science | History | Physics | Biology

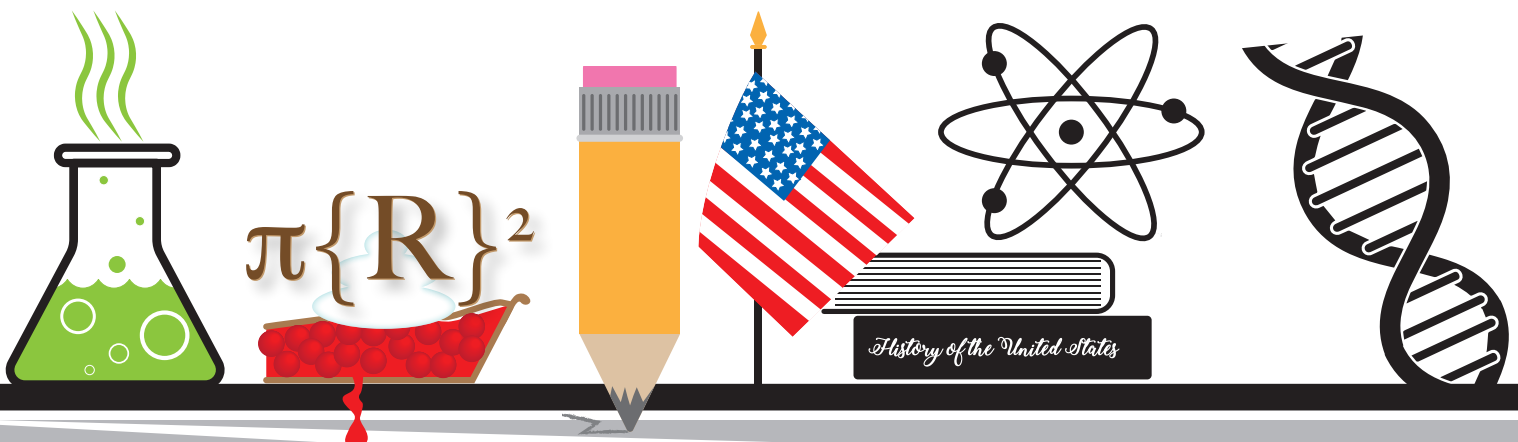

LEARNING COMMUNITIES 2022-2023

Learning Communities are residence halls with select areas designated for certain majors or special interest. Each Learning Community has specialized programming designed to increase access to faculty, staff and students pursuing common goals. All share a common goal of creating an educational environment that brings educators and students together to enhance student learning. There is no additional cost for participating in Learning Communities. Learning Communities are first come first serve.

Architecture &
Design
Clement Hall

Arts & Sciences
Humanities and
Social Sciences
Gates Hall

Business
Murray Hall

College of
Agricultural
Sciences &
Natural Resources
(CASNR)
Murrough Hall

Fine Arts
Wall Hall

First Gen
Weymouth Hall

First Year Success
Chitwood and
Weymouth Halls

Future Teachers
Hulen Hall

Global Leadership
Coleman Hall

Honors
Honors Hall

Media &
Communications
Murrough Hall

Pre-Health
Murrough Hall

Pre-Law
Murrough Hall

Students of Science,
Technology,
Engineering, and
Mathematics (STEM)
Sneed Hall

Transfer Connection
Gordon Hall

Women in Science &
Engineering (WISE)
Horn and
Knapp Halls

BUILT-IN FURNITURE

Each room includes:

- » Sink
- » Chests of drawers
- » Pull-out beds
- » Desks and chairs
- » Closets with overhead storage
- » Bookshelves
- » Academic Year Room Rate:
Double - \$4,675

CHITWOOD/WEYMOUTH/COLEMAN

Women and men live on alternating floors in both Chitwood and Weymouth. Chitwood and Weymouth Halls are for freshman only.

Weymouth Hall houses the First-Generation learning community. Both Chitwood and Weymouth Halls house the First Year Success Learning Community. Coleman Hall houses the Global Leadership Learning Community.

STANGEL/MURDOUGH COMPLEX

Women and men live in alternating wings in both Stangel and Murdough Halls. Murdough Hall houses the College of Agricultural Sciences & Natural Resources (CASNR), Pre-Health, Media & Communication, and PreLaw Learning Communities.

HULEN/CLEMENT COMPLEX

Women and men live on alternating floors in Hulen and Clement Halls. Hulen Hall houses the Future Teachers Learning Community (FTLC). Clement Hall houses the Architecture & Design Learning Community (ADLC).

WALL/GATES COMPLEX

Women and men live on alternating floors in Wall and Gates Halls. Wall Hall houses the Fine Arts Learning Community (FALC). Gates Hall houses the Arts and Sciences Humanities and Social Sciences Learning Community.

Built-In Furniture Floor Plan

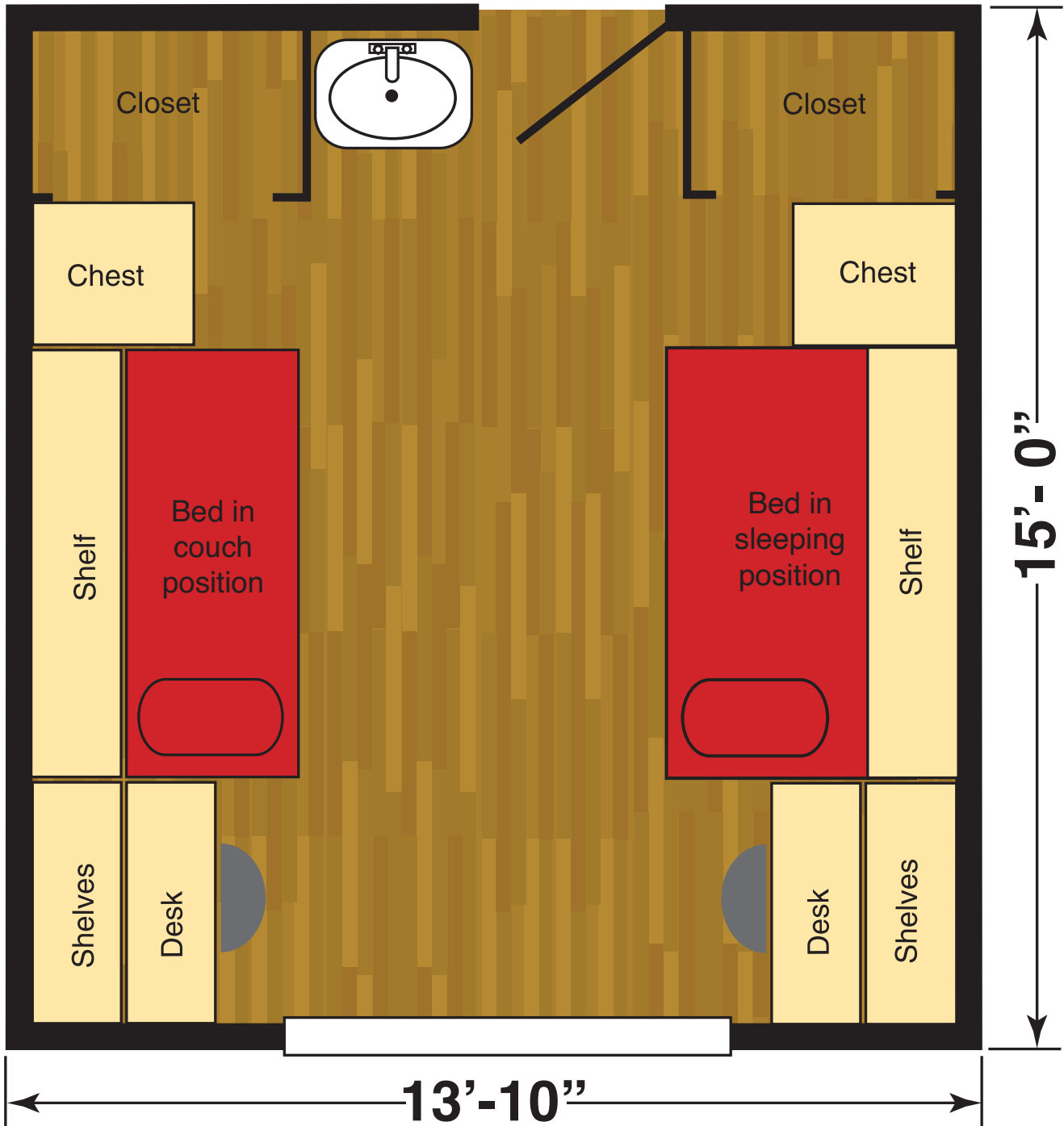

Stangel/Murdough, Chitwood/Weymouth/Coleman, Hulen/Clement, and Wall/Gates Halls.
See housing.ttu.edu/facilities/furnishings for a complete list of room and furniture dimensions.

**All room dimensions and amenities are subject to variation.*

MOVEABLE FURNITURE

Residence halls with moveable furniture gives the resident flexibility in furniture placement.

Each room includes:

- » Two beds
- » Two desks and chairs
- » Two chest of drawers
- » Sink
- » Ceiling fan
- » Closets
- » Each resident room has individual temperature controls
- » Academic Year Room Rate:
Double - \$4,675

SNEED HALL

Sneed Hall is an all-male residence hall that houses the Students of STEM Learning Community.

HORN/KNAPP HALL COMPLEX

Horn and Knapp are all-women residence halls. Knapp Hall houses the Women in Science & Engineering Learning Community (WISE).



Moveable Furniture Floor Plan

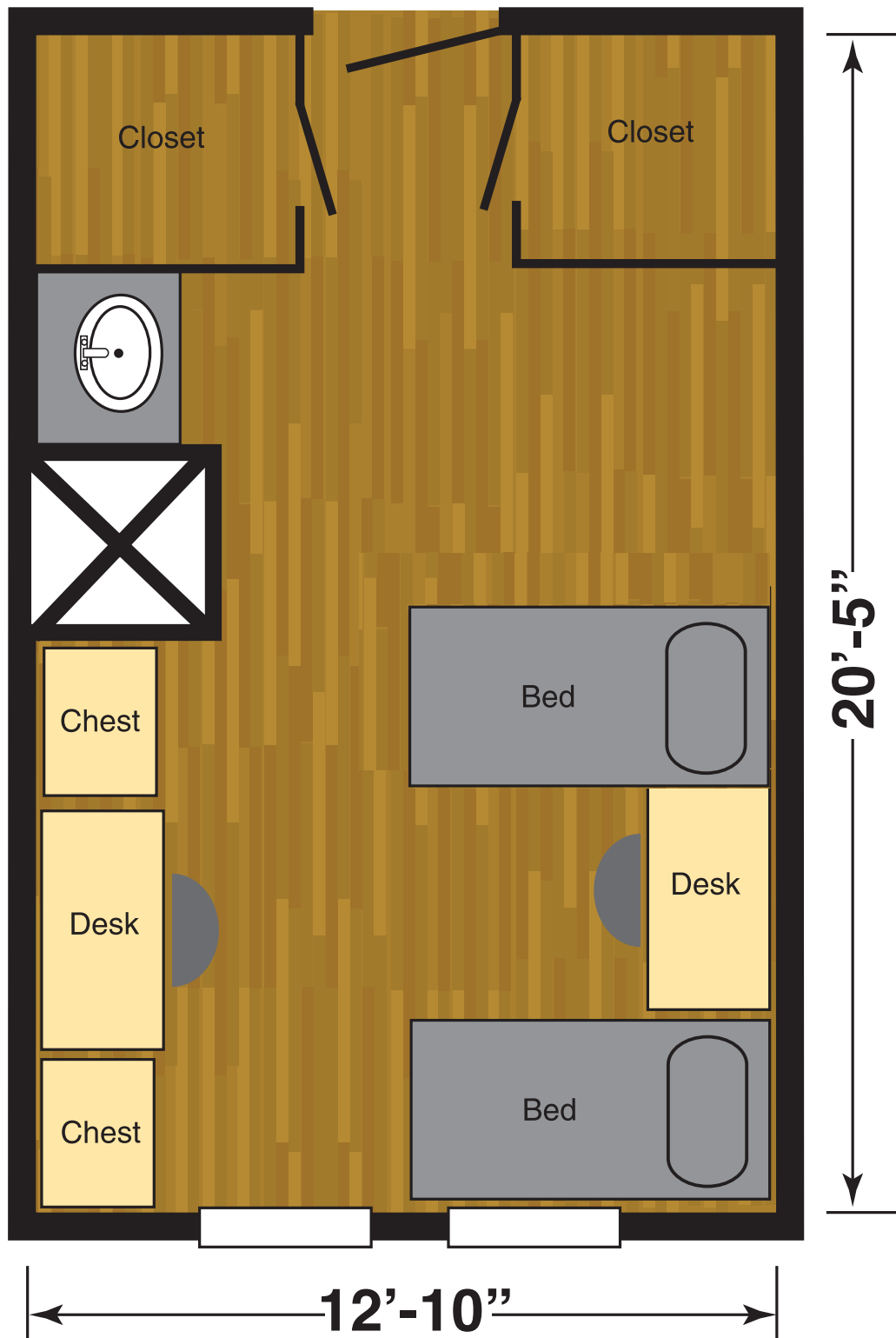

Sneed and Horn/Knapp Halls. See housing.ttu.edu/facilities/furnishings for a complete list of room and furniture dimensions.

**All room dimensions and amenities are subject to variation.*

SUITE-STYLE LIVING

MURRAY HALL

- » Shared living area and kitchenette
- » Three and four bedrooms
- » Semi-private bathrooms
- » Academic Year Room Rate:

- 3 Bedroom - \$6,800
- 4 Bedroom - \$6,600

Murray Hall is a suite-style residence for men and women. Up to four students of the same gender share a living area, have private rooms and semi-private bathrooms. Murray Hall is close to the Rawls College of Business and the engineering and science building. Murray Hall houses the Business Learning Community.

Four-Bedroom Suite–Murray

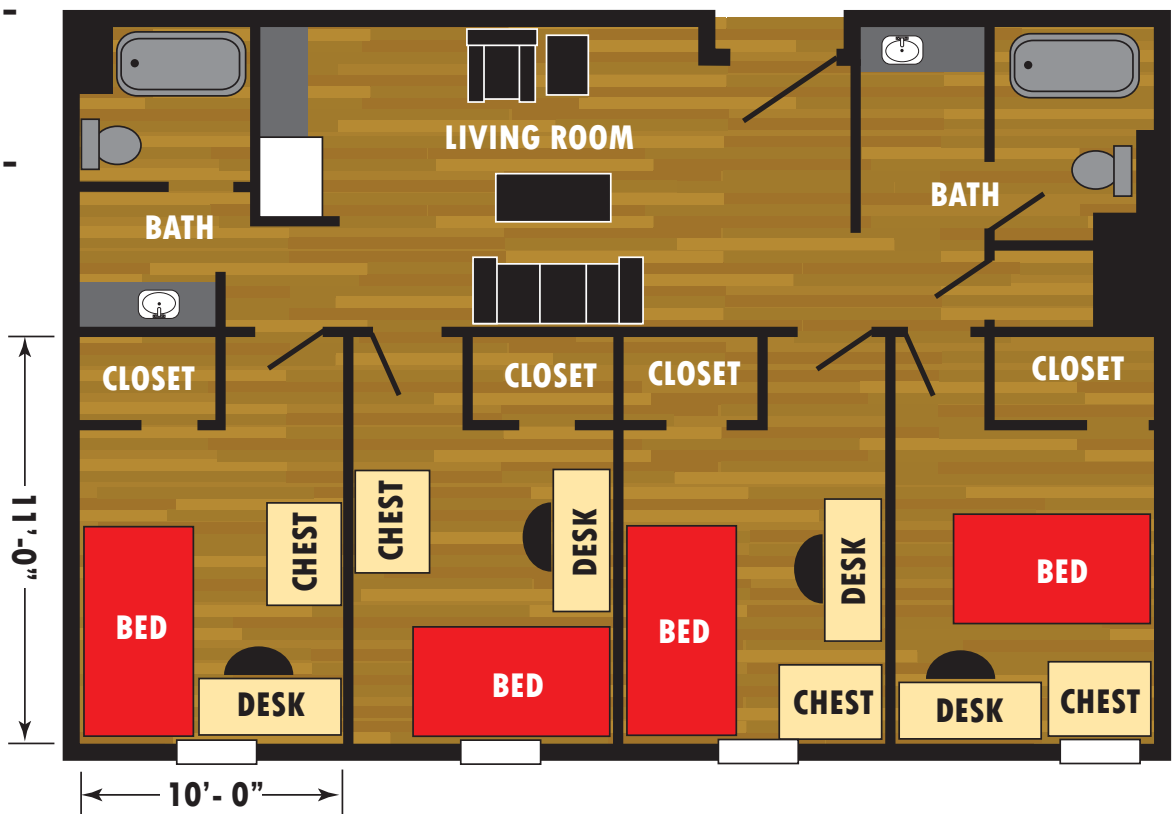

See housing.ttu.edu/facilities/furnishings for a complete list of room and furniture dimensions.

**All room dimensions and amenities are subject to variation.*

SUITE-STYLE LIVING

TALKINGTON HALL

Talkington Hall is a suite-style residence for men and women. With two-bedroom and four-bedroom suites, the students share a living area, have their own private room, and a semi-private bathroom. Talkington Hall is located near the Student Union Building, Library, and Music Building.

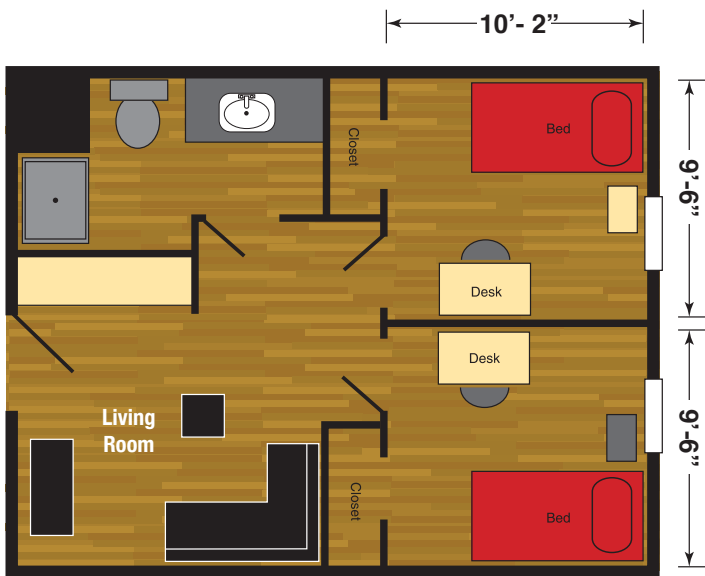

Two-Bedroom Suite–Talkington

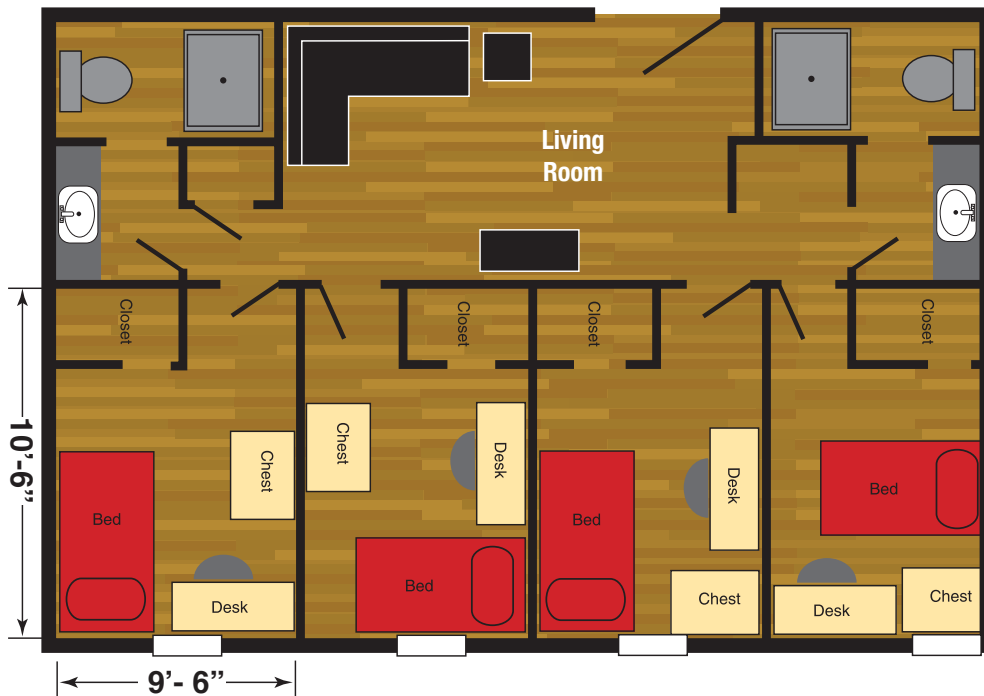

Four-Bedroom Suite–Talkington

- » Two and four bedroom suites
- » Shared living area and kitchenette
- » Semi-private bathrooms
- » Study lounges on each floor
- » Academic Year Room Rate:
 - 2 Bedroom - \$7,000
 - 4 Bedroom - \$6,600

See housing.ttu.edu/facilities/furnishings for a complete list of room and furniture dimensions.

**All room dimensions and amenities are subject to variation.*

SUITE-STYLE LIVING

» Suite-style living

GORDON HALL

» Furnished living room

» Two bedroom units

» Vanity area and semi-private bathroom

» Academic Year Room Rate:

Gordon Hall is a suite-style, two-bedroom residence for men and women. A fully furnished living room is between two private bedrooms shared by students, and each bedroom is equipped with a private bathroom. Gordon Hall houses the Transfer Connection Learning Community.

- Double/2 Bedroom - \$5,425

Two-Bedroom Suite-Gordon

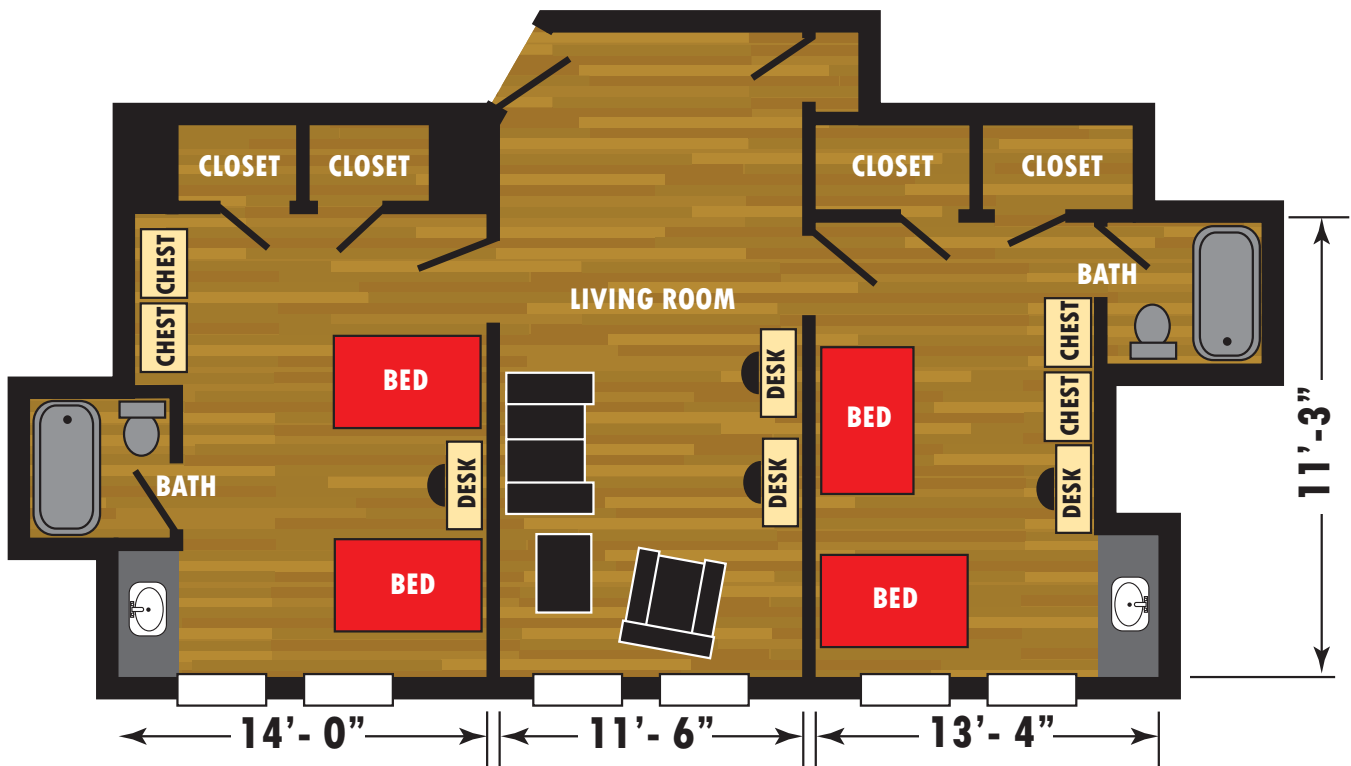

See housing.ttu.edu/facilities/furnishings for a complete list of room and furniture dimensions.

**All room dimensions and amenities are subject to variation.*



SUITE-STYLE LIVING

- » Three-bedroom townhouses
- » Four-bedroom flats
- » Living room and kitchenette
- » Semi-private bathrooms
- » Outside entrances
- » Academic Year Room Rate:

- 1 Bedroom - \$7,250
- 2 Bedroom - \$7,000
- 3 Bedroom - \$6,800
- 4 Bedroom - \$6,600

CARPENTER/WELLS

Carpenter/Wells is an upper-class, suite-style hall close to the Rawls College of Business, Engineering Key, and Science Key. Each suite has an exterior entrance. Suites with up to four rooms have a shared living area, private rooms, and semi-private bathrooms.

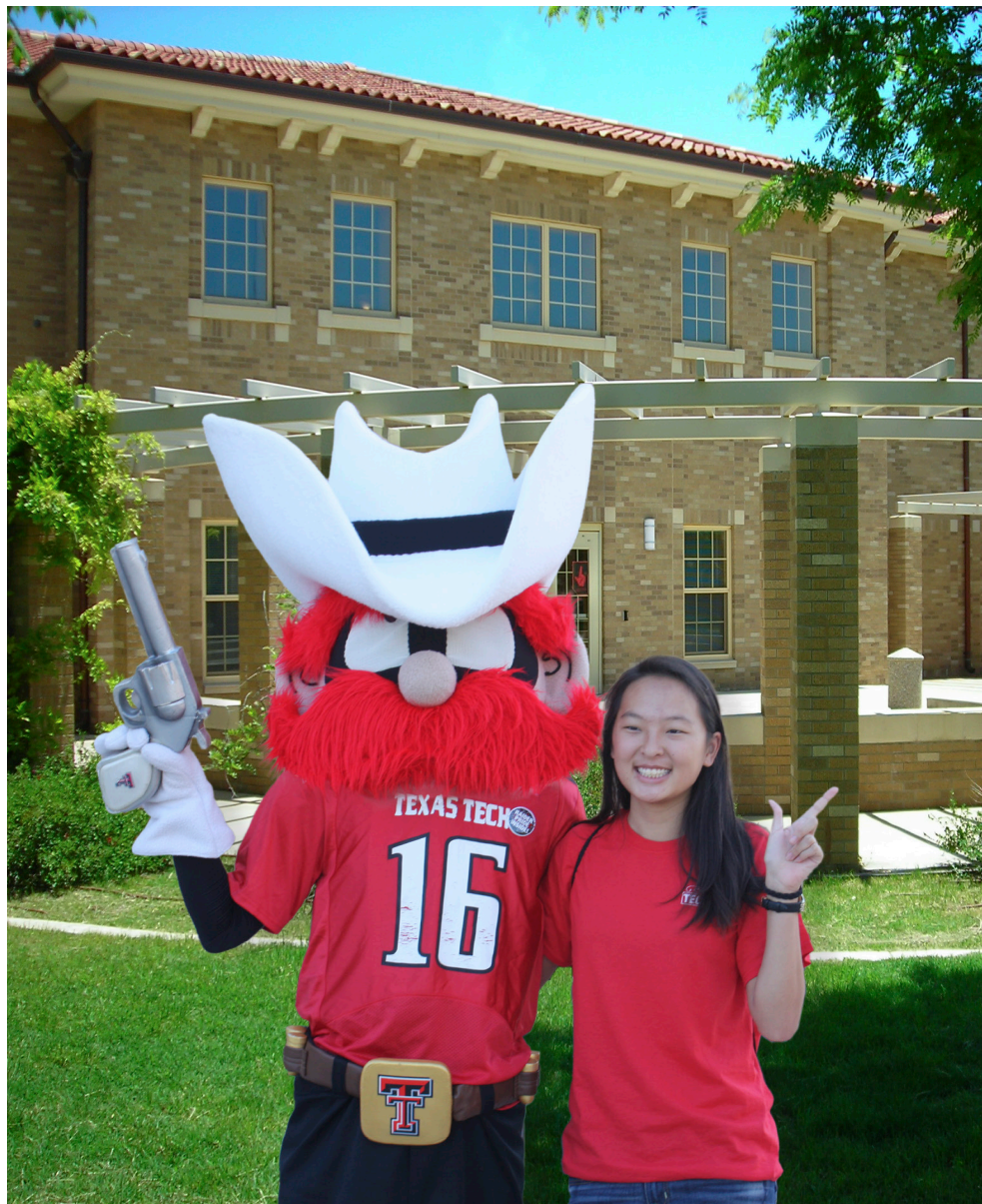



13'-6"
First



13'-6"
Second

Carpenter/Wells

Three-Bedroom Townhouse

9'-10"

9'-10"

Four-Bedroom Flat

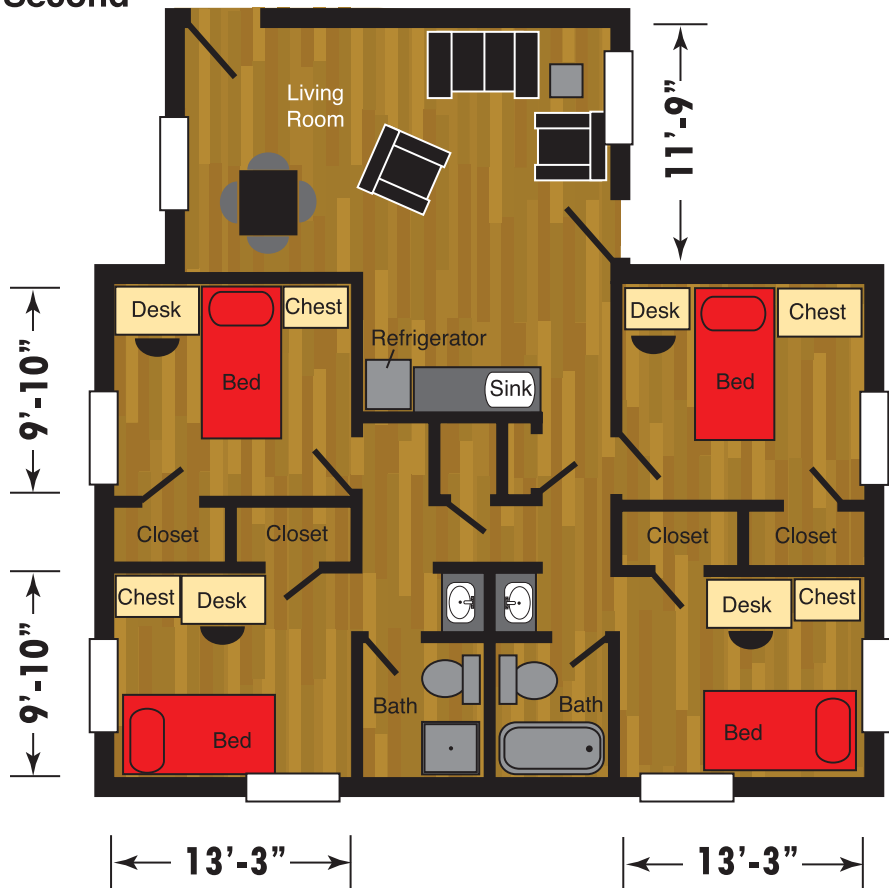

9'-10"

9'-10"

13'-3"

13'-3"

11'-9"

See housing.ttu.edu/facilities/furnishings for a complete list of room and furniture dimensions.

**All room dimensions and amenities are subject to variation.*

APARTMENT-STYLE LIVING

- » All utilities paid
- » Complete kitchens with dishwashers
- » Full-size beds
- » Washer/Dryer units in West Village B, Limitless Laundry rooms in West Village B
- » 9 and 12 month contracts available
- » Open year-round

WEST VILLAGE

West Village is an apartment-style hall located near the Law School on the southwest side of campus. Apartments can house one, two, or four students with a shared living area, private rooms, and semi-private bathrooms.

West Village Building A houses upper-level students sophomore and up. West Village Building B is for graduate students, 21 years old and up.

West Village A

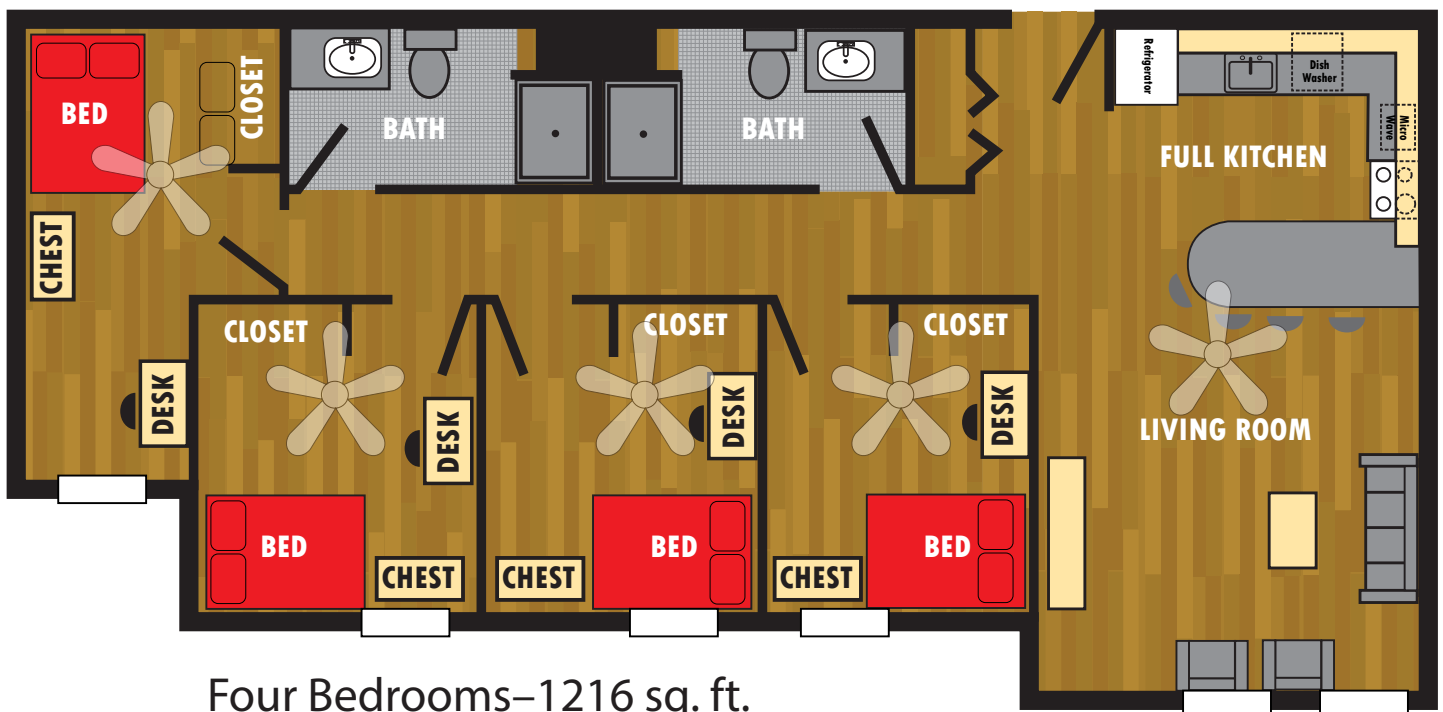

West Village B

One Bedroom - 447 sq. ft..

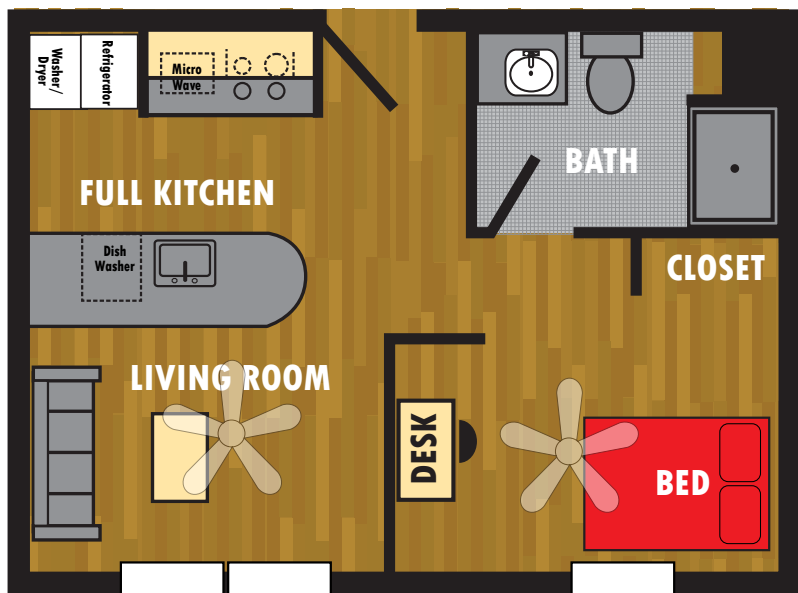

» Academic Year Rate for West Village A:

- 4 Bedroom - \$7,450

» Academic Year Rate for West Village B:

- 1 Bedroom - \$8,500

- 2 Bedroom - \$7,850

Two Bedrooms - 689 sq. ft.

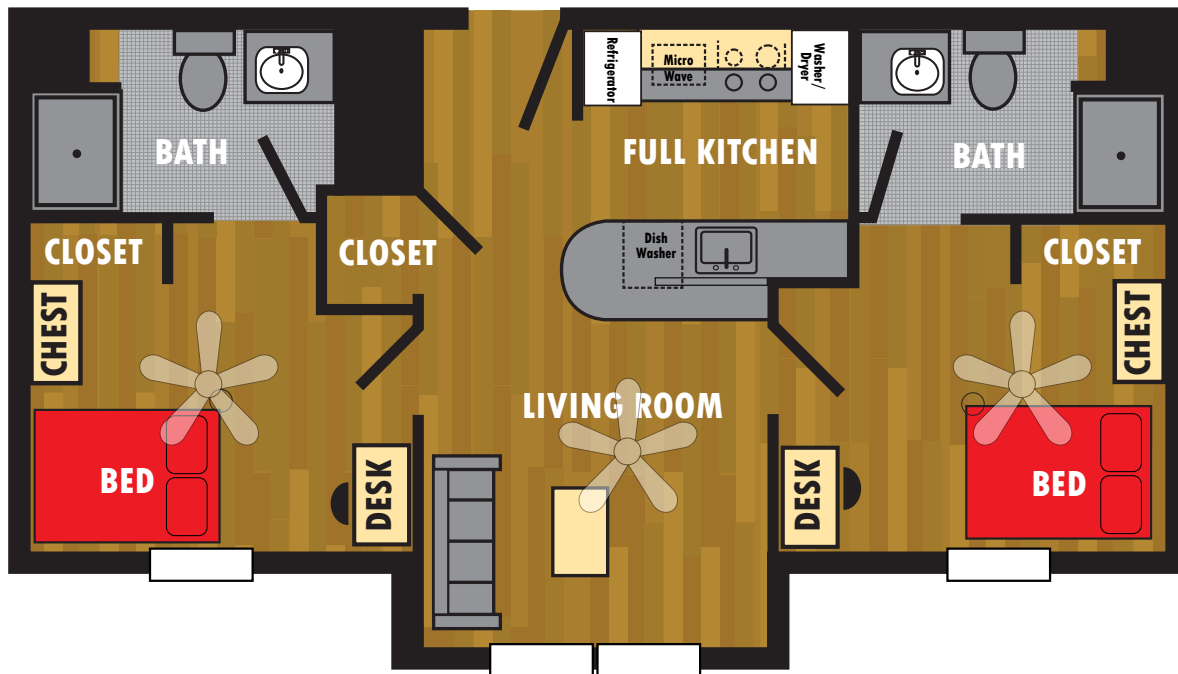

See housing.ttu.edu/facilities/furnishings for a complete list of room and furniture dimensions.

**All room dimensions and amenities are subject to variation.*

POD-STYLE LIVING

Features:

- » Two people per room
- » Beds can be lofted
- » One gender per pod
- » Shared and private bathrooms
- » Honors Learning Community
- » Full Starbucks® coffee shop
- » Academic Year Room Rate:
Double - \$5,950
- » Must be accepted to the Honors College to choose this living option

HONORS HALL

Honors Hall is a pod-style residence for men and women. Eight rooms are clustered around a central community bathroom to create a pod by gender. Each room has movable furniture and multiple study lounges adjacent to each pod. Located close to the Rawls College of Business, the Honors Hall houses the Honors Learning Community.

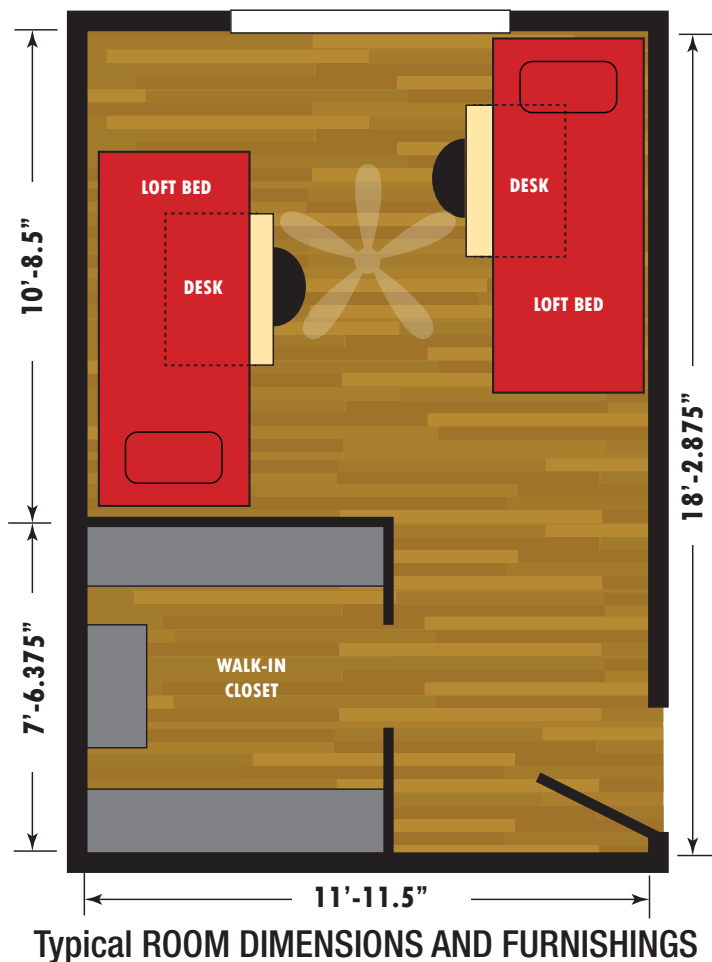

Typical Honors Hall Pod Layout



See housing.ttu.edu/facilities/furnishings for a complete list of room and furniture dimensions.

**All room dimensions and amenities are subject to variation.*

RATES FOR FALL 2022-SPRING 2023

Note: Rates for Academic Year 2022-2023 have not been finalized and approved and are subject to change.

	TOTAL FOR ACADEMIC YEAR	SPRING 2023 INCOMING
Built In Furniture: Traditional Halls - Double Occupancy		
Chitwood**	\$4,675	\$2,338
Clement	\$4,675	\$2,338
Coleman**	\$4,675	\$2,338
Gates	\$4,675	\$2,338
Hulen	\$4,675	\$2,338
Murdough	\$4,675	\$2,338
Stangel	\$4,675	\$2,338
Wall	\$4,675	\$2,338
Weymouth**	\$4,675	\$2,338
Moveable Furniture: Traditional Halls- Double Occupancy		
Horn*	\$4,675	\$2,338
Knapp*	\$4,675	\$2,338
Sneed*	\$4,675	\$2,338
Pod Style - Double Occupancy		
Honors	\$5,950	\$2,975
Suite Style		
Carpenter/Wells - 2 Bedrooms	\$7,000	\$3,500
Carpenter/Wells - 3 Bedrooms	\$6,800	\$3,400
Carpenter/Wells - 4 Bedrooms	\$6,600	\$3,300
Gordon- 2 Bedrooms (Double)	\$5,425	\$2,713
Murray - 3 Bedrooms	\$6,800	\$3,400
Murray - 4 Bedrooms	\$6,600	\$3,300
Talkington - 2 Bedrooms	\$7,000	\$3,500
Talkington - 4 Bedrooms	\$6,600	\$3,300
Traditional Hall Suite	\$5,425	\$2,713
Apartment Style		
West Village A - 4 Bedroom	\$7,450	\$3,725
West Village B - 2 Bedroom	\$7,850	\$3,925
West Village B - 1 Bedroom	\$8,500	\$4,250

**Quad rooms are available in Chitwood/Weymouth/Coleman at \$4,675 per academic year and \$2,338 spring only.

*Triple occupancy rooms are available at \$3,675 per academic year and \$1,470 spring only.

Please visit housing.ttu.edu for more rate details



TOMMY
HILFIGER
DESIGN

Handwritten notes on a green sticky note attached to the laptop lid.

Handwritten notes on a yellow sticky note being written on by the person.

Handwritten notes on a white spiral notebook.

Don't Forget!
Chem Exam



WELCOME TO
RAIDERLAND



TEXAS TECH UNIVERSITY

University Student Housing™

housing.ttu.edu