

The studio is based upon the premise that appropriate, culturally expressive, and sustainable architecture can be derived from an understanding of a range of factors including Local materials, construction processes, environmental context, local lifestyle and culture.

Borrowing from the Balinese belief in *sekala* (seen) and *niskala* (unseen), the studio will begin with analyzing case studies of architecture in Bali, in tropical climates, and noteworthy contemporary architecture around the world, that draws from the local. These constitute that which can be seen. The unseen will be the analyses and understanding of design strategies used in the case studies. Students will use lessons learnt from the case studies to derive concepts and strategies for their own design proposals. They will represent the 'seen' and the 'unseen' aspects of their design proposals using technical and presentation drawings, models and other forms of design communication.

Located within the traditional architectural context of Tenganan in Bali, Indonesia. the program will be a multifunctional community-oriented facility for health and wellness that will explore sustainability and harmony with the natural environment, important in traditional Balinese architecture and for the world today.

The challenge in this studio is on exploring and proposing innovative ways of bringing together tradition and modernity by understanding and drawing from the local while simultaneously addressing contemporary functions and global environmental concerns. It is an upper-level studio. Students taking this studio are expected to be self-motivated in learning and in eager in exploring multiple architectural strategies and design ideas. They will demonstrate how their design proposals relate to the site, local environmental conditions and architectural context while also meeting all program requirements for the proposed facility. The building will be primarily a community health center (approx. 500m²). It will be located just outside the main south entrance of Tenganan Pegringsingan village in Karangasem District in Bali, Indonesia in an area that is currently used for parking.

Aranha_Fall 22

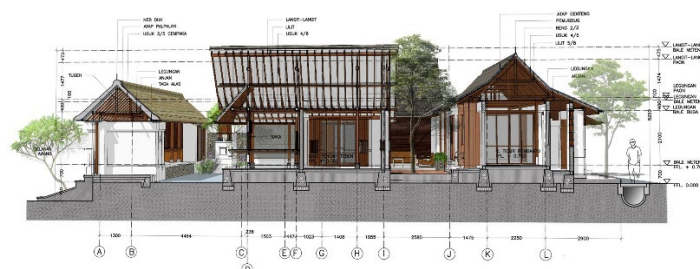

Drawing by Architect Putu Wiadnyana, Tenganan, Bali 2018