



WELCOME!

Texas Tech University Transportation and Parking Services is glad to have you on campus! Numerous parking options are available to our students, employees, and visitors.

All permits are license-plate-recognition based, so no stickers, hang tags, or paper dash passes are needed, just an accurate license plate number!

To purchase an ePermit, manage your My Parking Account, or get more information, visit <http://www.parking.ttu.edu>.



Download the Lime app to discover your nearest available vehicle.



VISITOR PARKING

| When | Where |
|--------------------------------------|---|
| Weekdays from 7:30 a.m. to 5:30 p.m. | Stop by a campus entry station for a free visitor ePermit for free visitor parking areas or directions to paid visitor parking. |
| Weekdays from 5:30 to 8 p.m. | Look for signs when parking. Some parking is free, some lots have an hourly cost, and some areas are reserved 24 hours per day. |
| Weekdays after 8 p.m. and Weekends | Nearly all area reserved (employee) lots and all commuter lots are free to use. Avoid residence hall lots and spaces reserved 24 hours per day. |
| Game Days | Contact the Red Raider Club for game-day parking options. |

EMPLOYEE PARKING

| ePermit | Parking location weekdays from 7:30 a.m. to 5:30 p.m. | Free parking in any employee lot after 5:30 p.m.* | Free parking at the Rec Center** | Drive through campus during working hours |
|-------------------------------|--|---|----------------------------------|---|
| Area Reserved | Designated lot starting with R and ending in two numbers | X | X | X |
| Reserved Space | A space solely for your use weekdays from 7:30 a.m. to 5:30 p.m. found within an Area Reserved lot | X | X | X |
| Flint Avenue Parking Facility | A Reserved Space or Area Reserved ePermit within the garage. Guaranteed covered parking | X | X | X |
| Motorcycle | Any designated motorcycle parking area | X | X | |
| Commuter | North, ICC, Raider Park, West, Satellite, or Evening | X | X | |



FREE CAR CLINIC & BIKE CLINIC

TPS brings professional mechanics to campus to examine vehicles and bicycles for free and identify any needed repairs. Twice a year for bikes. Three times a year for cars.



Motorist Assistance Program

MAP is available to anyone on the Texas Tech University campus who needs to air up a flat tire, one gallon of gas, jump start a vehicle, or unlock a vehicle. Call (806) 742-MAPP (6277).



RAIDER RIDE

Request a ride from 6 p.m. to 2:45 a.m. seven days a week through the TapRide app! A valid Student ID is needed. Rides are completely free, covering the entirety of campus. Student driver positions available.



Lime Scooter

Ride Safely, Park Responsibly

Safety is our number one priority. Wearing a helmet is highly recommended. Be mindful of pedestrians and other vehicles. Follow traffic laws and park scooters in designated parking areas.

STUDENT PARKING

| Living... | ePermit | Parking location weekdays from 7:30 a.m. to 5:30 p.m. | Free park-and-pay parking after 5:30 p.m.* | Free Rec Center parking** |
|------------------|---------------------|--|--|---------------------------|
| On Campus | Residence Hall | Z1, Z2, Z3, Z4, Z5, Z6, or Z7 req'd 24/7 | X | X |
| Off Campus | Commuter North | C1, C2, and C4. Any commuter lot after 2:30 p.m. | X | X |
| | Commuter ICC | C21 and C22. Any commuter lot after 2:30 p.m. | X | X |
| | Raider Park Garage | 4th floor and above. Any commuter lot after 2:30 p.m. | X | X |
| | Commuter West | C10, C11, C12, C14, C15, and C16. Any commuter lot after 2:30 p.m. | X | X |
| On or Off Campus | Commuter Satellite | S1. Any commuter lot after 2:30 p.m. | X | X |
| | Evening Commuter | S1 before 2:30 p.m. Any commuter lot after 2:30 p.m. | X | X |
| | Motorcycle | Designated motorcycle parking areas | X | X |
| | Flint Avenue Garage | 1st floor W. half, 2nd floor, 3rd floor | X | X |

* Watch for and avoid spaces reserved for 24 hours within lots.

** Rec Center parking has a two-hour maximum for all patrons.

PURCHASING A PERMIT

New employees visit the TPS office for the first purchase. Students purchase online using these steps:

1. Have your eRaider login information, license plate or VIN, and, if living on campus, your housing assignment secured.
2. Go to www.parking.ttu.edu and click *My Parking* in the top right corner then *My Parking Account*.
3. Select *Texas Tech University eRaider Sign In*.
4. If logging in for the first time, follow directions to create your account.
5. Once you reach the dashboard, select *Buy Permit* in the *Registered Vehicles* tab.
6. Follow the steps to select the term you need the permit and which permit you want. If your preferred permit is sold out, it will appear in the steps as a wait-list option.
7. Pay for the permit by either paying online with a credit or debit card or by adding to tuition.

USING BUSES

Every TTU student rides for free on any Citibus, the TTU busing provider, with a valid student ID. For full bus routes, including apartment and city routes, visit www.citibus.com.

Download the DoubleMap app for live bus tracking!



BIKES & SCOOTERS

Visit www.parking.ttu.edu/bicycle for rules and information!

TEXAS TECH UNIVERSITY
Transportation & Parking Services

Open Weekdays
7:30 a.m. to 5:30 p.m.

2903 4th Street, Suite 145
Admin. Support Center,
Lubbock, Texas
79409-3161

(806) 742-PARK
parking@ttu.edu

www.parking.ttu.edu
www.transportation.ttu.edu

[i](#) [f](#) [y](#) [t](#) @TTUParking

BUILDING INDEX

| | | | |
|---|----|--|----|
| ADMINISTRATION | 4C | LIVESTOCK ARENA & MEATS LAB | 2C |
| ADMINISTRATIVE SUPPORT | 3A | MADDOX ENGINEERING RES CTR | 4C |
| AGRICULTURAL MECHANIZATION AND EDUCATION | 4C | MATHEMATICAL SCIENCES | 4C |
| AGRICULTURAL PAVILION | 4C | McINTURFF CONFERENCE CTR | 1B |
| AGRICULTURAL SCIENCES | 4C | McCLELLAN HALL | 4D |
| ANIMAL SCIENCE | 2C | MAEDGEN THEATRE | 3D |
| AQUATIC CENTER | 3C | MEAT LAB & LIVESTOCK ARENA | 2C |
| ARCHITECTURE | 3D | MECHANICAL ENGINEERING | 4B |
| ART | 3D | MEDIA & COMMUNICATION | 3C |
| ART 3D ANNEX | 2C | MERKET ALUMNI CENTER | 4D |
| ATHLETIC SERVICES | 3B | MOODY PLANETARIUM | 2A |
| ATHLETIC TRAINING CENTER | 4B | MUSEUM | 2A |
| BIOLOGY | 3C | MUSIC | 4D |
| BURKHART CENTER FOR AUTISM LAB | 3D | NATURAL SCIENCE RESEARCH LAB | 2B |
| BUSINESS ADMINISTRATION | 3C | PETROLEUM ENGINEERING | 4B |
| CASNR ANNEX | 3C | PHILOSOPHY & ENGLISH | 3D |
| CHACP #1 | 2C | PHYSICAL PLANT | 3B |
| CHACP #2 | 1B | PLANT SCIENCE | 3C |
| CENTRAL WAREHOUSE | 3C | PRESTON SMITH LIBRARY | 1B |
| CHEMICAL ENGINEERING | 4B | PSYCHOLOGY | 4D |
| CHEMISTRY | 4C | RAIDERPARK GARAGE | 4A |
| CHILD DEVELOPMENT RESEARCH CENTER | 4C | RANCHING HERITAGE CENTER | 3A |
| CITY BANK COLISEUM/AUDITORIUM | 4B | RECREATIONAL CENTER | 2C |
| CIVIL ENGINEERING | 4B | RONALD MCDONALD HOUSE | 2C |
| CLASSICAL & MODERN LANG & LIT | 3D | SPORTS PERFORMANCE CENTER | 4B |
| COMPUTER CENTER | 4B | SOUTHWEST COLL/SPECIAL COLL | 4C |
| DAN LAW FIELD | 4B | SCIENCE | 4C |
| DEVELOPMENT OFFICE | 4D | STUDENT UNION | 4D |
| DOAK HALL | 4C | STUDENT WELLNESS CENTER | 3B |
| DOUBLE T ZONE | 4A | STUDENT RECREATION CENTER | 2C |
| DRANE HALL | 4D | TEXAS TECH POLICE | 3A |
| EDUCATION | 3D | TEXAS TECH SYSTEM BUILDING | 1D |
| ELECTRICAL ENGINEERING | 4B | TTU HEALTH SCIENCES CENTER | 1B |
| ENG AND MATERIALS RESEARCH | 4C | UNIVERSITY COLLEGE | 2B |
| ENGINEERING CENTER | 4B | UNIVERSITY PARKING SERVICES | 3A |
| ENGINEERING LAB | 4B | UNITED SUPERMARKETS ARENA | 2D |
| ENGLISH & PHILOSOPHY | 3D | UNIVERSITY GREENHOUSES | 2C |
| EX-STUDENTS ASSOCIATION | 4D | UNIVERSITY MEDICAL CENTER | 2B |
| EXERCISE AND SPORTS SCIENCES | 3C | UNIVERSITY THEATRE | 3D |
| EXPERIMENTAL SCIENCE | 3C | U.S.D.A. PLANT STRESS AND FISHERIES AND WILDLIFE | 1A |
| FLINT AVE. PARKING FACILITY | 3D | VEHICLE RENTAL | 3B |
| FOOD SCIENCE | 4C | WEST HALL | 4C |
| FOOD TECHNOLOGY | 4C | WIGGINS (COMPLEX DINING FAC.) | 3D |
| FOOTBALL TRAINING FACILITY | 4B | | |
| FRAZIER PAVILION | 4A | | |
| FULLER TRACK | 3B | | |
| GODDARD RANGE, WILDLIFE, & FISHERIES MANAGEMENT | 3C | | |
| GARRISON GERIATRIC CENTER | 1A | | |
| HEALTH SCIENCES CENTER | 1B | | |
| HOLDEN HALL | 4C | | |
| HOUSING SERVICES | 2C | | |
| HOUSING OFFICE & WIGGINS | 3D | | |
| HUMAN SCIENCES | 4C | | |
| INDUSTRIAL MAN. & SYSTEMS ENG | 4B | | |
| INNOVATION HUB | 1A | | |
| INTERNATIONAL CULTURAL CENTER | 2B | | |
| JONES AT&T STADIUM | 4A | | |
| JOURNALISM | 4C | | |
| KTXT-TV | 2D | | |
| LAW SCHOOL | 2D | | |
| LEISURE POOL | 3C | | |
| LIBRARY | 4D | | |
| LIVERMORE CENTER | 4B | | |

Residence Halls

| | |
|----------------------------|----|
| BLEDSE HALL | 4B |
| CARPENTER/WELLS | 3B |
| CHITWOOD HALL | 3D |
| CLEMENT HALL | 3D |
| COLEMAN HALL | 3D |
| GATES HALL | 4D |
| GORDON HALL | 4B |
| HONORS HALL | 3B |
| HORN HALL | 4D |
| HULEN HALL | 3D |
| KNAPP HALL | 4D |
| MURDOUGH HALL | 3C |
| MURRAY HALL | 3B |
| SAM'S PLACE WEST / WIGGINS | 3D |
| SNEED HALL | 4C |
| STANGEL HALL | 3C |
| TALKINGTON HALL & COMMONS | 4D |
| WALL HALL | 4D |
| WEEKS HALL | 4C |
| WEST VILLAGE | 2D |
| WEYMOUTH HALL | 3D |

| | | | |
|--|---|--|---|
| | FACULTY & STAFF | | VISITOR |
| | RESIDENCE HALLS | | TIME LIMIT |
| | COMMUTER NORTH | | TWO WHEEL |
| | COMMUTER RAIDERPARK | | ADA |
| | COMMUTER WEST | | DAYTIME PARK & PAY (all vehicles pay meter) |
| | COMMUTER SATELLITE | | EVENING PARK & PAY (must have current TTU permit OR pay meter) |
| | COMMUTER ICC | | EMERGENCY PHONE |
| | TRAFFIC CONTROL POINT (employee, visitor and service permits only beyond this point) | | |

SYMBOLS ON MAP ONLY INDICATE APPROXIMATE LOCATION OF PARKING SPACES AND DO NOT REPRESENT ACTUAL NUMBER OF PARKING SPACES IN LOT.

BUS ROUTE TRANSFER POINTS MARKED IN BOLD ITALICS
These transfer points offer a chance to transfer to off-campus bus routes.

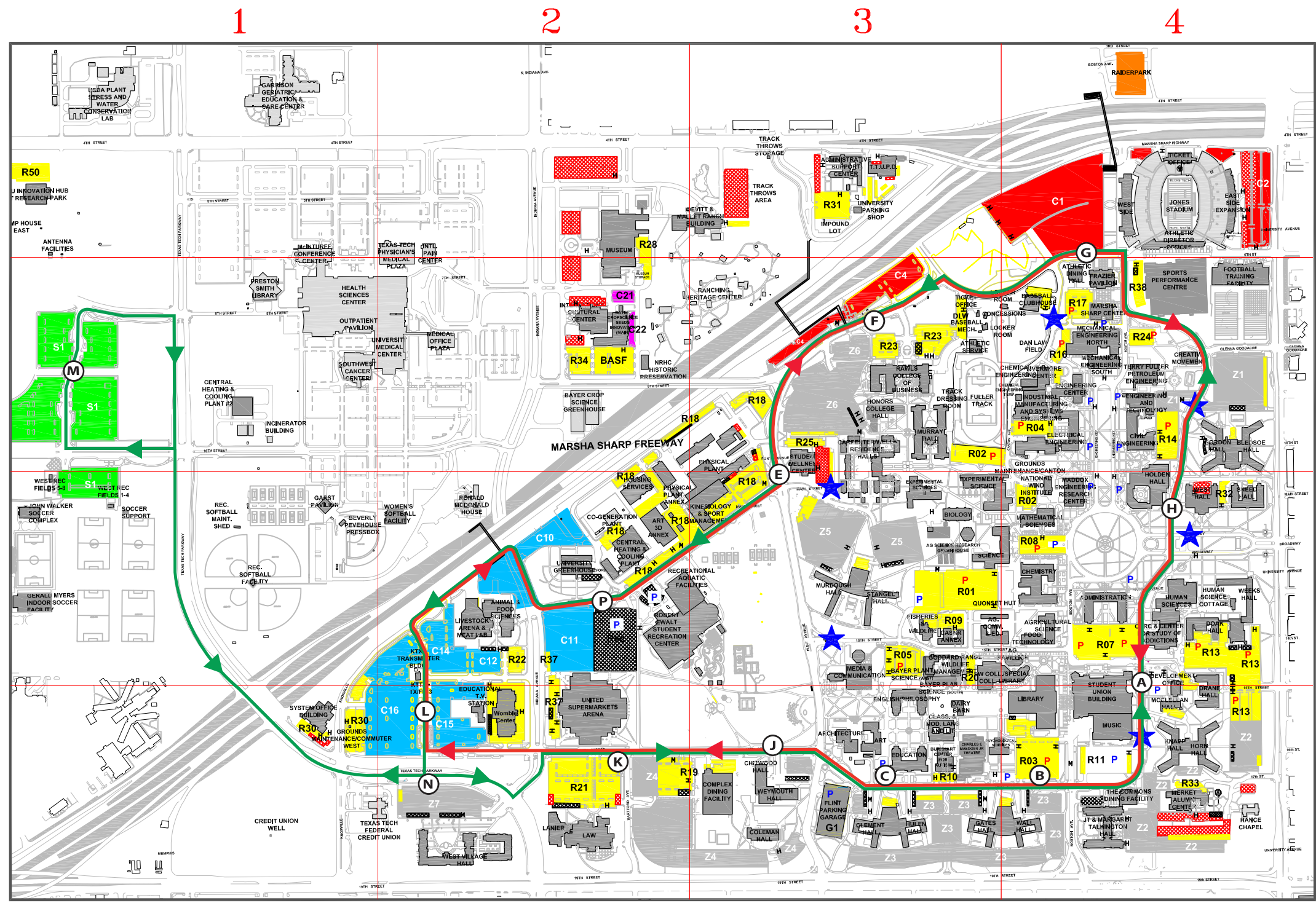

41 Double T Bus Route
Circles campus counterclockwise
7:25 a.m. to 6:59 p.m.
Every 5 minutes*

| | |
|-----------------|--|
| L | Commuter West |
| M | Commuter Satellite S1 |
| N | West Village |
| K | Law School (on demand) |
| J | Chitwood - Weymouth |
| <i>B</i> | <i>Library / Wall - Gates</i> |
| <i>A</i> | <i>Student Union Building (SUB)</i> |
| <i>H</i> | <i>Holden Hall</i> |
| G | Commuter North C1 |
| <i>F</i> | <i>Business Administration (BA)</i> |
| P | Rec Center |

42 Red Raider Bus Route
Circles campus clockwise
7:25 a.m. to 7:17 p.m.
Every 6 minutes*

| | |
|-----------------|--|
| L | Commuter West |
| P | Rec Center |
| E | Student Wellness Center |
| <i>F</i> | <i>Business Administration (BA)</i> |
| G | Commuter North C1 |
| <i>H</i> | <i>Holden Hall</i> |
| <i>A</i> | <i>Student Union Building (SUB)</i> |
| <i>B</i> | <i>Library / Wall - Gates</i> |
| C | Education |
| J | Chitwood - Weymouth |
| K | Law School (on demand) |